

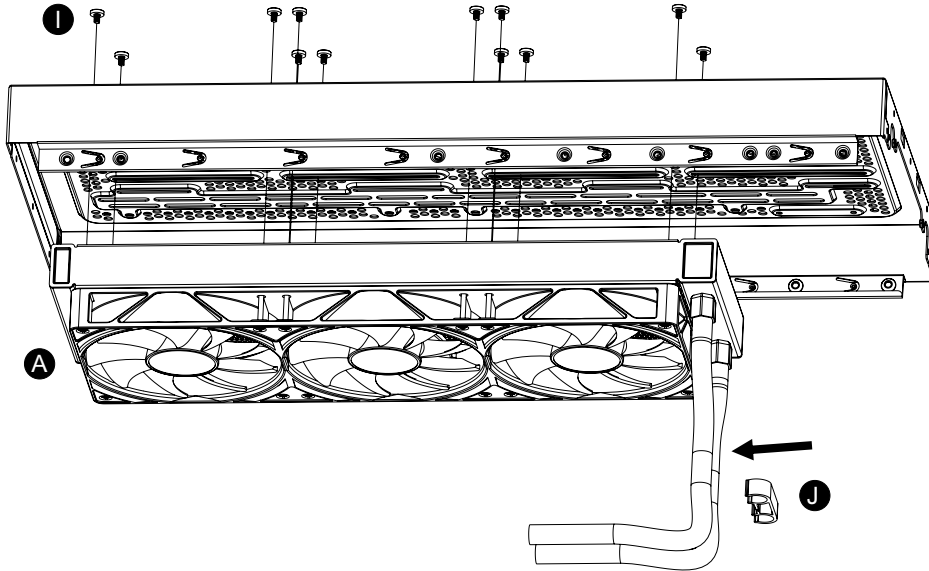

# Installation Guide

1



2

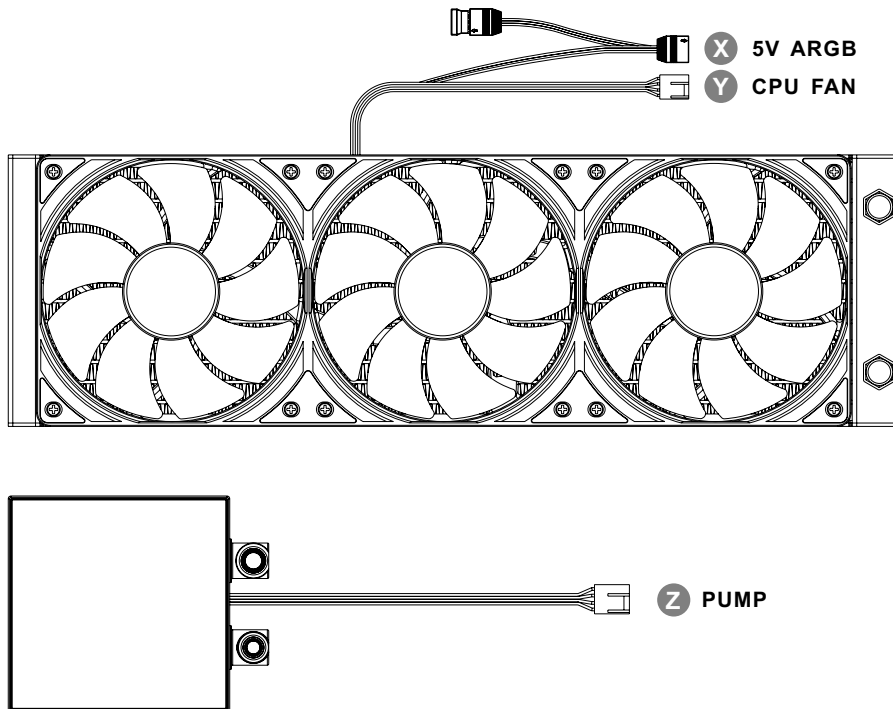

3

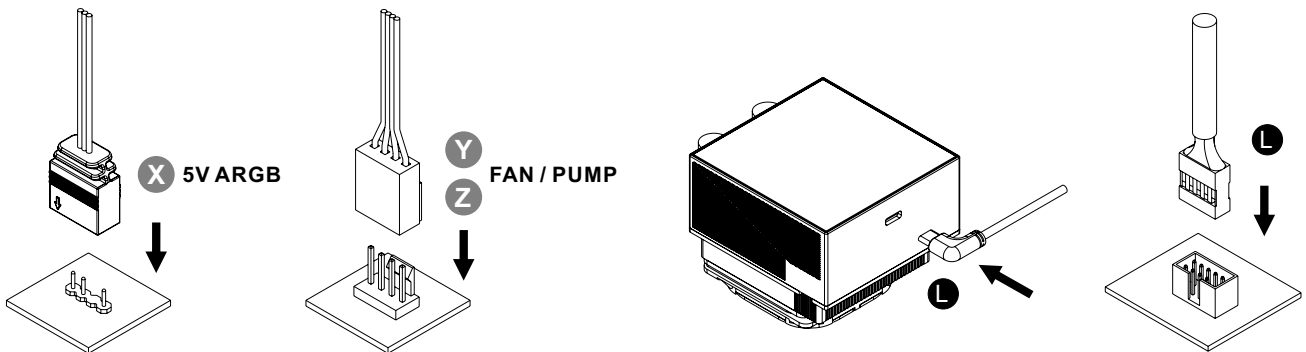

## ⚠ CAUTION

Please power off the PC and check the Positive and Negative ends on the connector before connecting the cable to motherboard. Connecting the wrong end can damage the fans.

## ⚠ CAUTION

To control the LCD display by TT RGB PLUS Software, Please connect the water block and motherboard with cable L.