

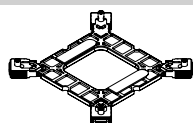

Parts List

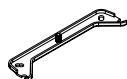

A x 1



B x 2



Intel
C x 4



Blue
D x 4



Black
E x 4



AMD
F x 4



G x 1

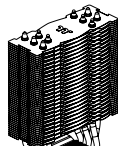

H x 1

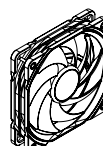

I x 1

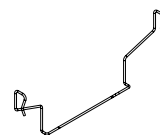

J x 2

Intel Installation Guide

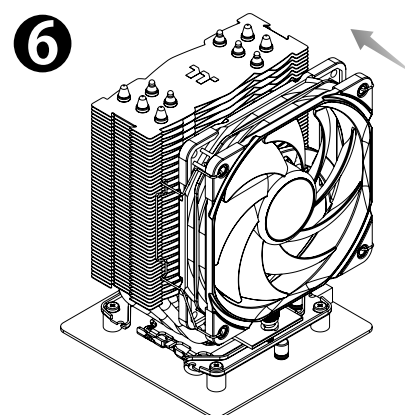
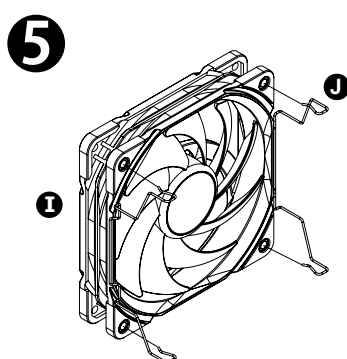
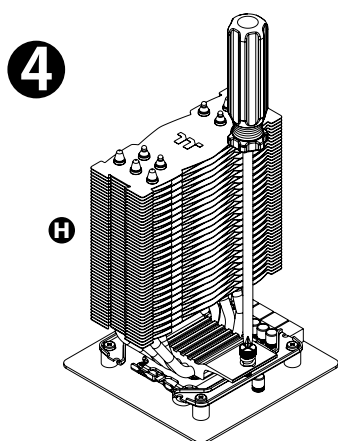
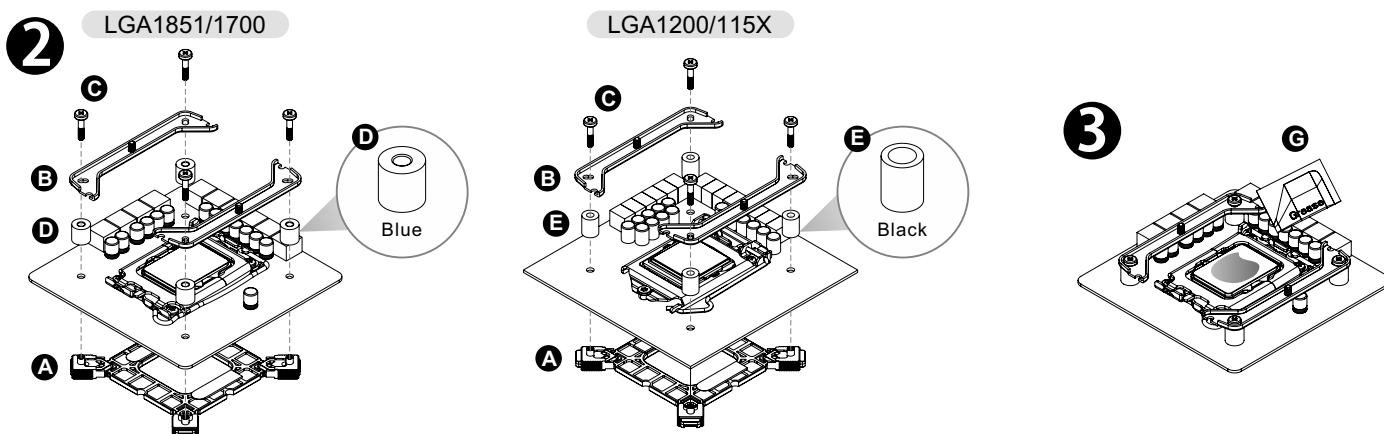
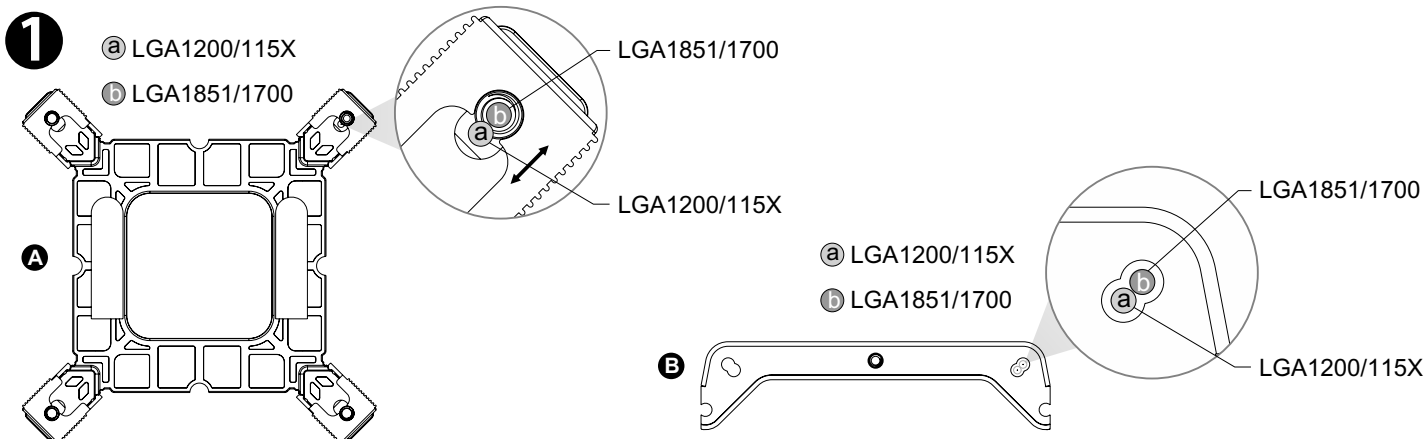

AMD Installation Guide

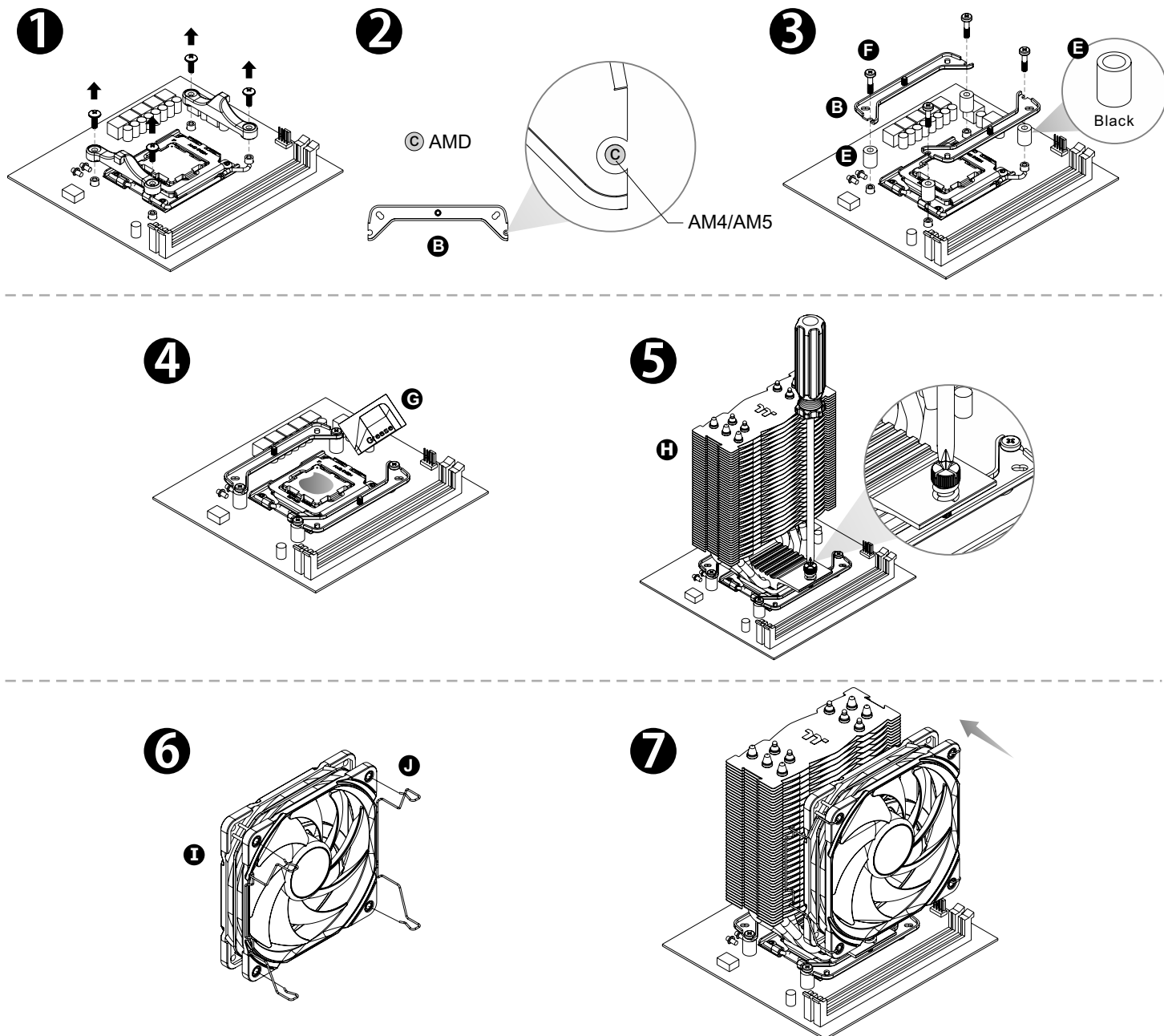

Fan & MB SYNC Installation Guide

CAUTION Please power off the PC and check the Positive and Negative ends on the connector before connecting the cable to mainboard. Connecting the wrong end can damage the fans.

