

Parts list

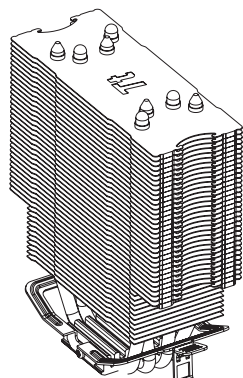

A x 1

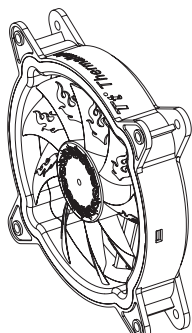

B x 1

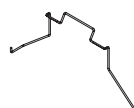

C x 2

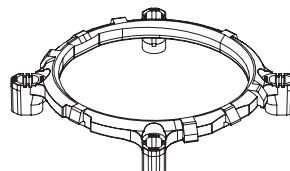

D x 1



E x 1



F x 4



G x 4

INTEL

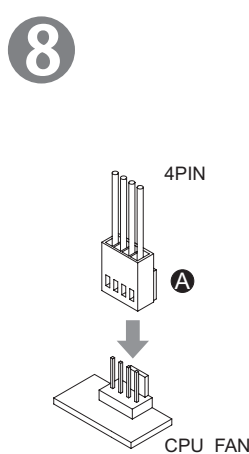
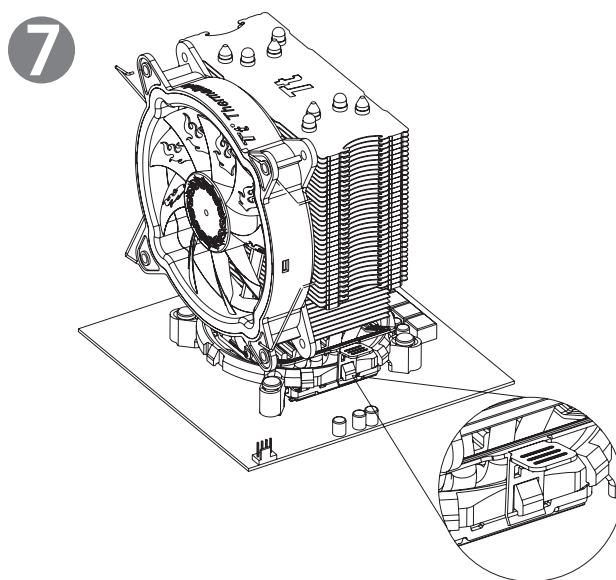
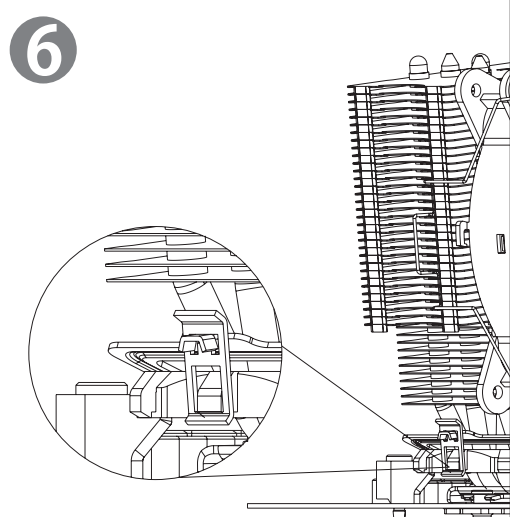
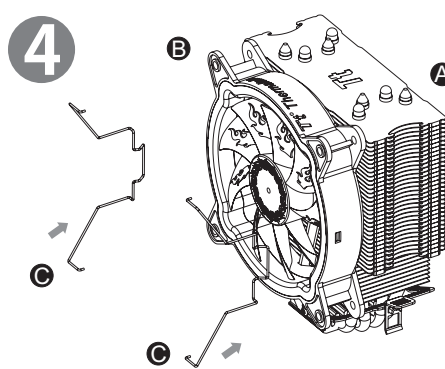
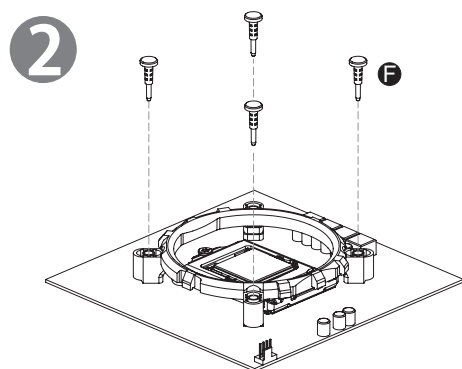
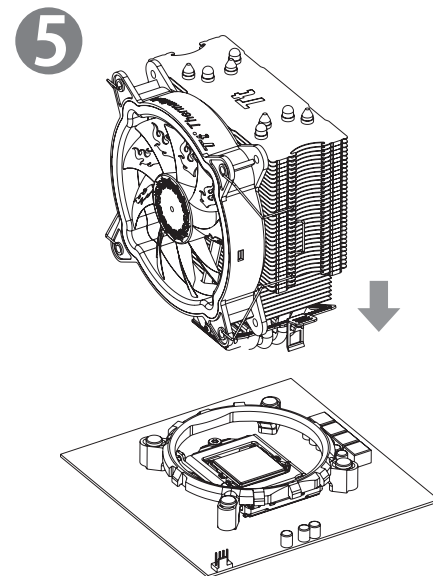
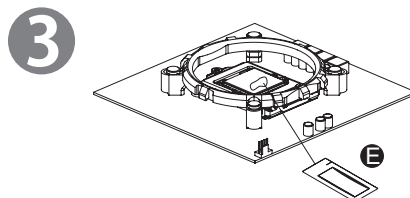
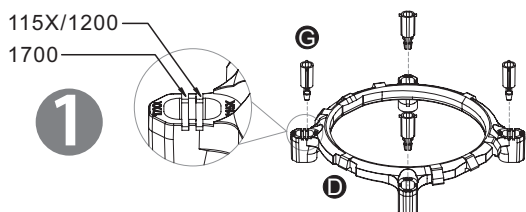

AMD

1

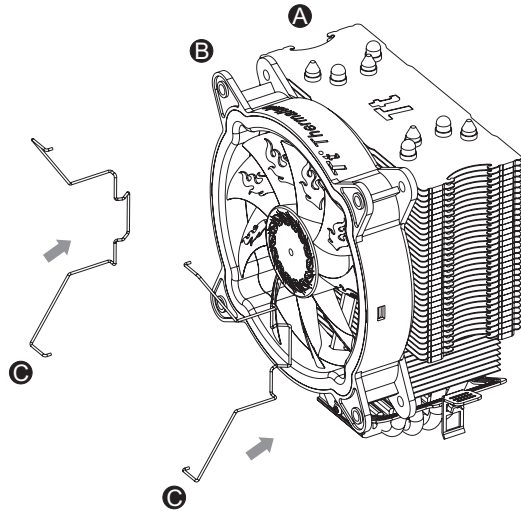

2

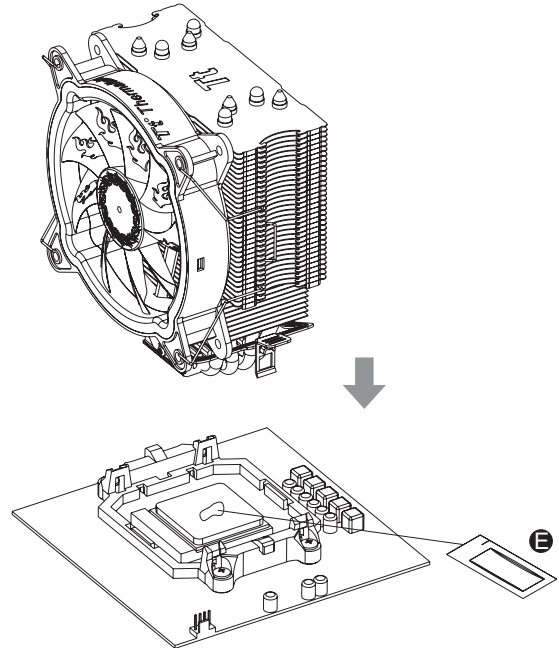

3

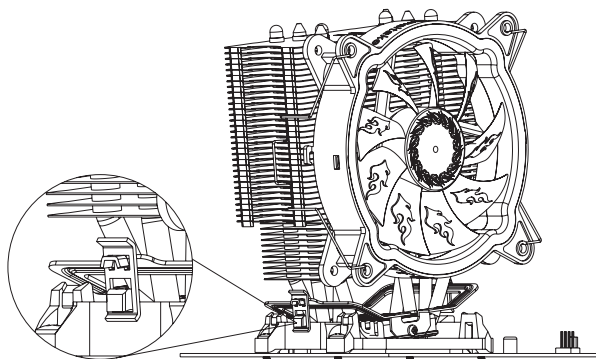

4

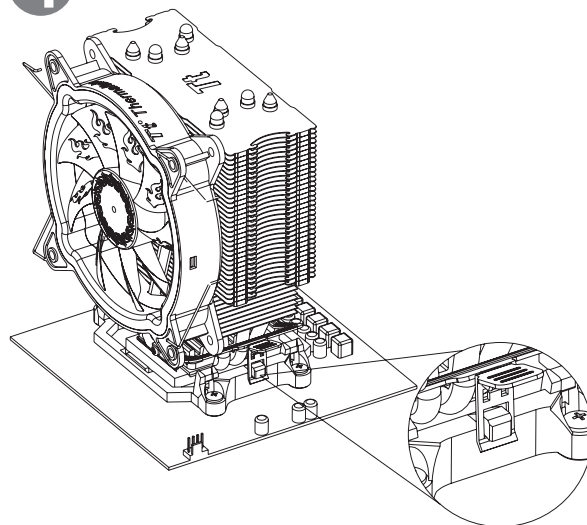

5

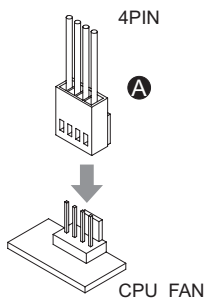

MB SYNC

CAUTION

Please power off the PC and check the Positive and Negative ends on the connector before connecting the cable to motherboard. Connecting the wrong end can damage the fans.

ASUS

Aura Addressable Strip Header(s)

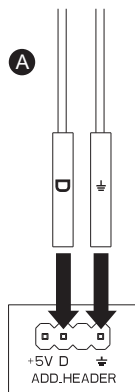

MSI

JRGB-strip Header(S)

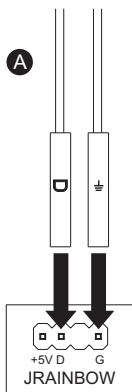

ASROCK

Addressable RGB LED Header(s)

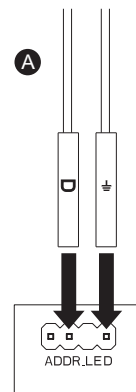

GIGABYTE

AOURS RGB Fusion with Digital LEDs

